

SHARP

Be Original.

BP-30C25

Digital Full Colour Multifunction System



Compact Cubic MFD
Fit for your business



A **versatile MFD** to upgrade the way you work

Here is a smart and user-friendly MFP designed to fit in anywhere. Inside its clean and compact frame, it packs a huge range of essential functions to streamline your workflow. This versatile full-colour A3 MFP is built to match a diverse range of work styles. As a key player in your office team, it will drive your business forward into new realms of value.

Compact
Size

All-in-one
functionality

Stylish
Design



Fits various business scenarios

Harnessing the versatility of digital data can help you streamline your operations and grab new business opportunities.

[See more on pages 5-6](#)

Fits your everyday office needs

The LCD touchscreen with Easy UI mode gives everyone on your team easy access to everyday functions on the MFD.

[See more on pages 3-4](#)





Fits your security demands

A secure environment supports admin staff in their duties and protects your business from risk.

[See more on pages 9-10](#)

Fits a range of work styles

Because the MFD can connect to a variety of mobile devices and cloud services, you and your team can work anytime, anywhere.

[See more on pages 7-8](#)



Fits your **everyday** office needs.

- Want an MFD that can be used intuitively.
- Want neat, high-quality output.
- Want an environmentally friendly workplace.



7.0- Inch LCD Touchscreen

The 7.0-inch colour LCD touchscreen makes it easy for anyone to use the MFD's advanced functions. The function icons incorporate a simple, straightforward design. Each user can customise the home screen by drag-and-dropping icons for commonly used functions.



LED Status Lamps

On the control panel are two LED lamps: one red, one green. These light up to notify you—even from a distance—that, for example, the machine is “now printing” or “out of paper.”

Pop-up Command Screen

Insert a USB drive into the MFP and a command screen will automatically pop up on the LCD. Right away you can print files from the USB drive—which are displayed as thumbnails*—or you can scan documents directly to the USB drive.

*Previews of Microsoft® Office files require optional MX-PU10.



Easy UI Mode

In Easy UI mode, the touchscreen displays simple icons for frequently used functions like duplexing and paper size selection.



*Previews of Microsoft® Office files require optional MX-PU10.

Quick Login

Just tap your dedicated user icon to access a personally customised operation screen. Customisable items include initial settings and onscreen language.



Add a user—it's simple and easy.



Adding a user is easy via the touchscreen control panel. Simply choose an icon from the template.

Choose an icon.

Free-Tilting Control Panel

The control panel can be tilted freely at various angles. This gives you easy viewing and easy operation, no matter where the MFP is placed or who is using it.



Easy Scanning

Tap on the LCD touchscreen's Auto Set button to have the MFP perform a host of actions automatically. It can determine scan resolution, skip blank pages in a multi-page document, or reorient pages mixed in upside down*. Automatic functions like these save you time and effort, while ensuring optimal scan results.

*Requires optional MX-EB20.



Home screen



Easy Scan mode

- Automated settings that match the document.
The MFP can tell whether a document being scanned is colour or B/W. If it is B/W it can automatically select the optimal setting for text—monochrome or greyscale.

- Corrects skewed documents.
The MFP detects skewed documents* and automatically adjusts them, so you don't have to re-scan them.
*PDF format only.

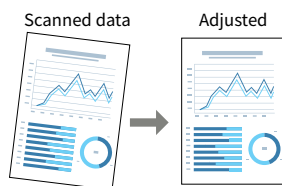

Fast Wake Up from Sleep Mode

This MFP recovers quickly from energy-saving Sleep mode. Placing a document in the RSPF or touching the LCD control panel wakes the MFP up in just one second*. This helps to minimise waiting time and get your jobs done faster.

*When in Fast Wake Up mode.



Energy Efficient

To reduce power consumption, Sharp has applied its advanced technologies across all areas of this MFP. Energy-saving functions include a short warm-up time and low power consumption of only 0.5 W* in fax or network standby mode.

*May vary depending on usage environments.

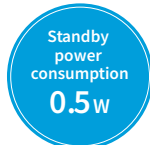

Auto Power Shut-Off

To save electricity, an auto power shut-off function automatically puts the MFP into energy-saving mode after a period of inactivity. Shortly before this mode begins, a message appears on the LCD indicating that the MFP will soon shut down and giving you the option to continue operation.

Easy, High-Quality Scanning and Copying

Through an advanced three-step process, Auto Colour Mode provides faithful and fully automated copying and scanning in both colour and B/W—all with a simple press of the Start button. Here's how it works: Auto Colour Selection automatically determines whether a page is colour or B/W. Auto Original Type Selection then analyses page contents to distinguish between different components (such as photos, text, and text on halftone backgrounds) and selects the appropriate mode. It uses machine learning to optimally reproduce text and images. Finally, Background Suppression* automatically removes unnecessary background colour.

*May not work depending on the colour of the background or type of document.

Auto Colour Mode

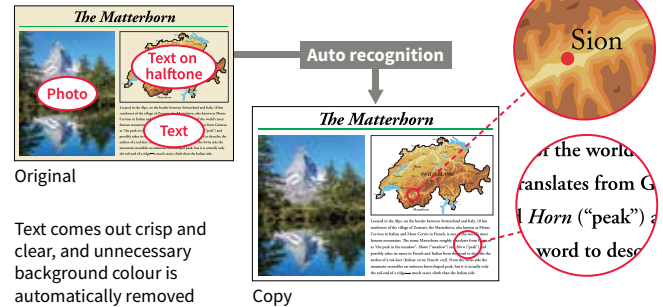

Automatic Document Feeding

An RSPF (reversing single pass feeder) efficiently feeds in up to 100 sheets of either one- or two-sided originals. Because you can feed in a batch of multiple pages at once, it boosts copying and scanning efficiency.



Automatic Toner Cartridge

This function expels completely empty cartridges in preparation for replacement. The cartridge is replaced only after all the toner has been consumed, thereby ensuring efficient use of toner. Because you can tell at a glance when cartridges are empty, they are fast and easy to replace.

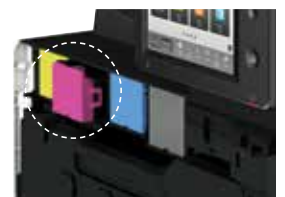

Power ON/OFF Schedule

This function automatically turns the MFP on or off per administrator-set schedules.

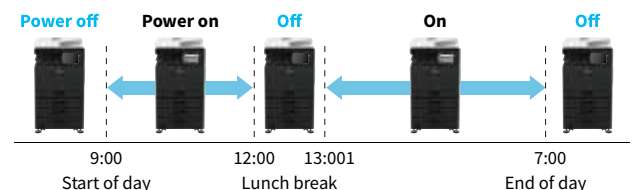

Eco Recommendation

This function suggests environmentally friendly settings before a print*/copy command is executed from the control panel.

*For printing Document Filing data and direct printing (FTP/SMB/USB).

Fits various business scenarios

- Want to reduce paper use.
- Want to use digital data effectively.
- Want to streamline business processes.



Card Shot Function

The MFD lets you easily copy both sides of a card onto a single page. Whether it's an ID card or a driver's license, you save time, effort, and paper.

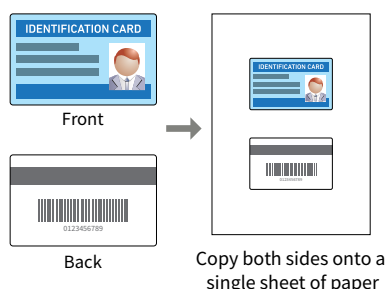

Versatile Paper Handling

On the control panel are two LED lamps: one red, one green. These light up to notify you—even from a distance—that, for example, the machine is “now printing” or “out of paper.”

Pop-up Command Screen

The main unit paper tray can take paper sizes from A3 to A5, while the multi bypass tray can also handle A6 paper. The optional paper feed units handle paper up to 220 g/m², while the multi bypass tray takes paper up to 256 g/m²*1. In addition to plain paper, the MFP can handle a number of other paper types*2, such as envelopes, removable adhesive paper, and glossy paper.

*1: 256 g/m² paper cannot be fed via main unit paper tray.

*2: Must be fed via multi bypass tray.

Envelopes

Perforated card stock

Rye	Sourdough
\$2.00	\$4.50
Baguette	Cinnamon roll
\$3.50	\$3.25
Focaccia	Hot cross bun
\$4.75	\$2.25
Whole wheat	Spinach & feta roll
\$4.25	\$3.75
Multi-grain	Kaiser roll
\$5.00	\$1.75

Price cards

Cardboard

Note: Contact a Sharp customer representative for details.

Printing Two Pages on One Sheet

Duplex printing allows printing on both sides of a sheet of paper. The MFP can also print two pages of content on the same side of a sheet of paper. Using both of these functions at the same time lets you print four pages on one sheet. It's a great way to reduce paper use and cut paper costs.

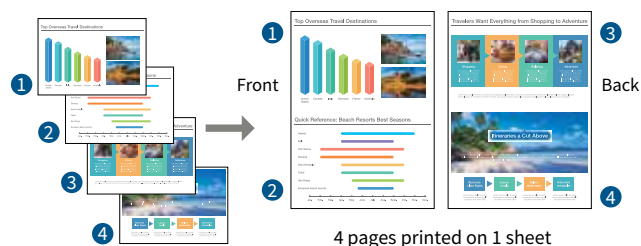

Rotation Sort*

Every other copy of a document is rotated 90 degrees when it's delivered to the output tray. This takes the hassle out of sorting copies and comes in handy when you need to print many copies of multi-page documents.

*Two paper trays must be loaded with the same-sized paper in a different orientation (landscape and portrait).

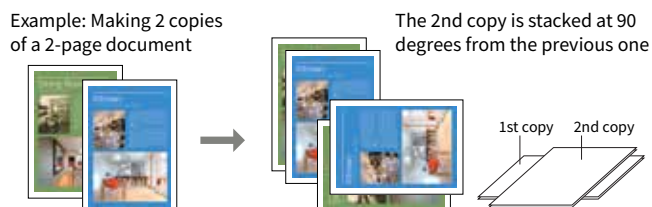

Custom Images

By storing image files of your choice—like your company's logo—on the MFD, you can easily add them to copies and printouts.

Multicrop and Image Crop Functions

Multiple receipts, photos, and other items can be scanned all at once, with each one saved as a separate file. This helps you streamline the filing of receipts and bills. The MFP can also crop photos from documents such as magazine pages and save them as individual files.

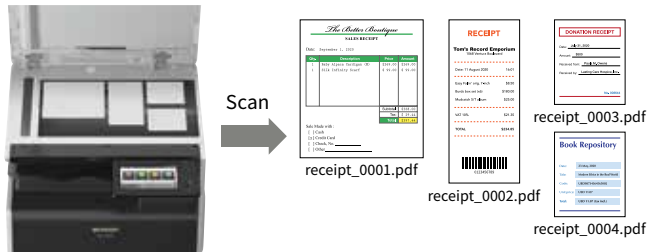

Convert Documents via OCR*

OCR capability on this MFP lets you convert a scanned document into a searchable PDF file or into an editable Office Open XML (docx, xlsx, pptx) file.

*Requires optional MX-EB20.

Business Card Scanning*

The MFP can scan multiple business cards at once. It reads the contact details on each card via OCR* and then exports the details to your chosen contact management system.

*Requires optional MX-EB20.

Versatile Fax Functions*

The MFP gives you all the benefits of standard fax functionality. It also supports paperless faxing, so you can check faxes anytime, anywhere and respond accordingly. You'll be able to handle all sorts of fax-related work with ease.

*Fax requires optional MX-FX15, and Internet fax requires optional MX-FWX1.

Inbound routing

Inbound routing lets you forward incoming faxes to a pre-designated location, such as a PC desktop*, FTP server, network folder, or email address without printing to paper. This allows you to check faxes even when you're out of the office, and it makes it easier to separate incoming faxes intended for different recipients.

*Requires Network Scanner Tool Lite.

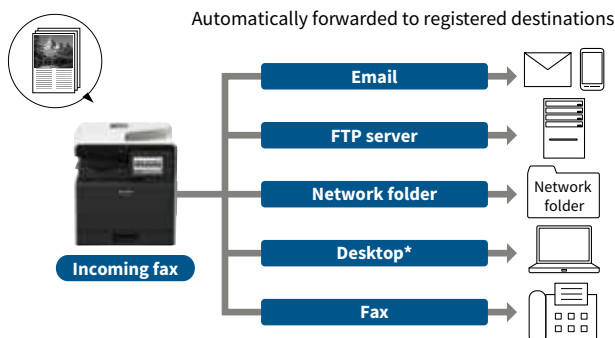

Multiple Scan Destinations

There are many ways to distribute scanned documents. They can be sent to an FTP server, to a network folder, or to a USB drive. Or they can be sent directly to a designated PC desktop*¹ or as email attachments. A compact PDF function*² ensures that PDF files are sent and received smoothly.

*1: Requires Network Scanner Tool Lite.

*2: Requires optional MX-EB19.

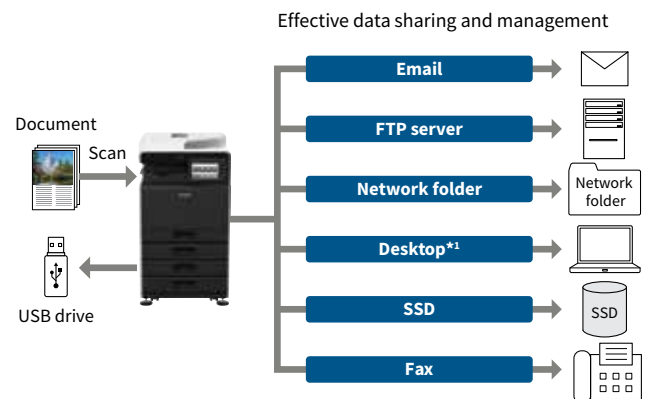

Network Scanner ToolLite*

The Network Scanner ToolLite lets you send documents scanned on the MFP to your PC or mobile device and save them in a specified folder there. It can even work if you're out at a client's office. Network Scanner Tool Lite can detect the nearest MFP and let you upload scans to your laptop or mobile device. There's no need to make special settings.

*Download from the following website: <https://global.sharp/products/copier/downloads/>

Incoming fax autosave and preview

The MFP automatically saves incoming fax data. It allows you to preview faxes on the LCD control panel before printing them out. This gives you the option of printing them out if needed, deleting them, or forwarding them to a PC or mobile device. You can also keep them on the MFP's storage device to use at a later time. Because the MFP can save incoming faxes without immediately printing them, it can reduce your paper and toner usage.

Internet fax

This MFD lets you exchange faxes via email with other compliant fax machines. Compared to conventional phone line faxing, Internet faxing saves on telecommunication costs.

PC-fax transmission

You can directly send a document created on your PC to a recipient's fax machine via the MFP. This saves time, effort, and paper, because you don't need to print the document before faxing it.

Fits a range of work styles

- Want to keep up with diversifying work styles.
- Want to print or scan from devices other than PCs.
- Want to access the company system from outside the office.



Link with Mobile Devices*

Connecting the MFP to one or more mobile devices is easy, and it expands your options for sharing data. Not only can you send scanned documents to mobile devices such as smartphones and tablets, you can also print documents or photos sent from those devices.

*Requires wireless LAN connection or optional MX-EB18.



Sharpdesk Mobile*

This print/scan app lets you easily link your mobile device to the MFP by simply holding it over the MFP's NFC card reader*² or by scanning the MFP's QR Code®.

*1: For details, see the Sharpdesk Mobile support website:

https://global.sharp/products/copier/docu_solutions/mobile/sharpdesk_mobile/

*2: The NFC interface is for Android™ devices running Android 9 or earlier. Requires third-party NFC card reader. Contact a Sharp customer representative for details.

Sharp Print Service Plugin*

This mobile printing technology allows printing from Android devices.

*Available at a later date. For details, see the Sharp Print Service Plugin support website: https://global.sharp/products/copier/docu_solutions/mobile/Sharp_Print_Service_Plugin/index.html
Requires optional MX-PK13.

Airprint*

The MFP supports the AirPrint printing feature in Apple devices. It lets you print directly from a mobile device without the need for a print driver.

*Requires optional MX-PK13. Requires optional MX-PK13.

Wireless Connections*

The MFP offers ultra-handly wireless access, enabling convenient access to the MFP even from places where it's difficult to connect a LAN cable.

*Requires optional MX-EB18.

Link with Mail Servers

Scanned data can be conveniently sent via your regular Gmail™ or Microsoft Exchange/Online* account.

*Exchange Server 2010/2013/2016, Exchange Online

Office Direct Printing*

Print common Microsoft Office files without using a PC. With this MFP, you can print a Word, Excel®, or PowerPoint® file directly from a mobile device, cloud service, USB drive, or file server.

*Requires optional MX-PU10. The actual printout may look different from what is displayed on the computer screen. This function is enabled via Qualcomm® DirectOffice™ technology.



Link to Cloud Services*1

The MFP connects with cloud services directly from its control panel, letting you upload scanned data to or print directly from any of them*2. Once you log in to the MFP, its single sign-on feature allows you to quickly access multiple software services without having to sign in to each one separately. You can also download and install apps on your MFP via Sharp's Application Portal. App updates are easily recognisable, so you'll always be up-to-date on the latest services.

*1: Requires optional MX-AMX2. Contact a Sharp customer representative for details.

*2: Direct printing of PDF files requires optional MX-PK13; direct printing of Microsoft Office (pptx, xlsx, docx) files requires optional MX-PU10.

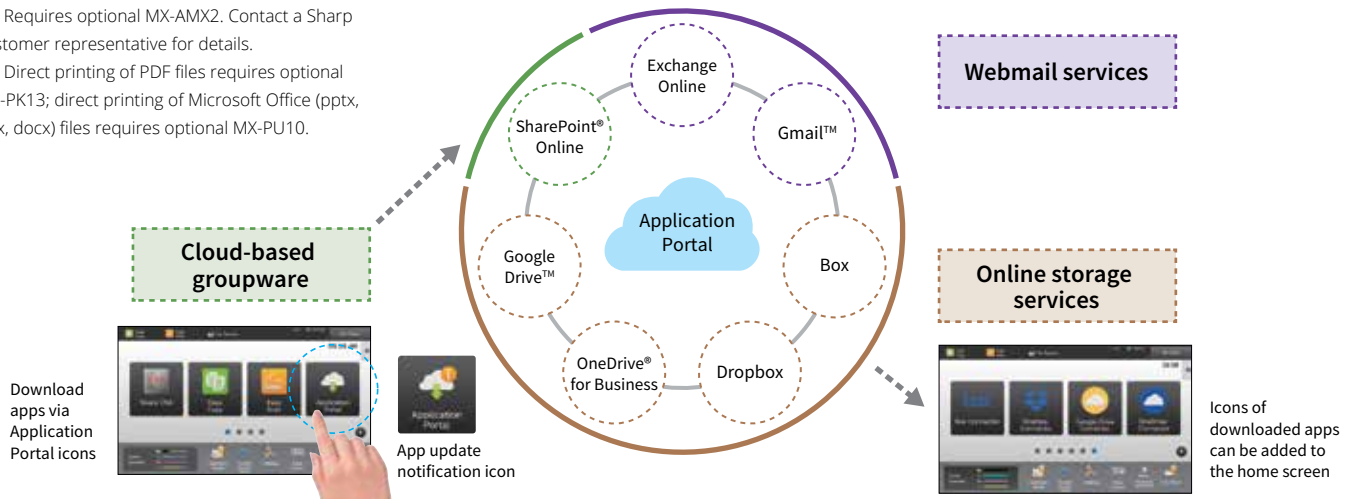

Print Release*

The Print Release function lets you send documents to the main MFP. This MFP acts as a server and stores them for printing out from any other compatible MFP on the network. The document won't be output until you log in to the MFP, select the document, and execute a print command. This prevents you from printing the wrong document, forgetting documents in the output tray, or having others see your confidential documents. Print Release is easy to set up for admin staff and doesn't need a separate server.

*Contact a Sharp customer representative for details on the recommended maximum number of connectable MFPs.

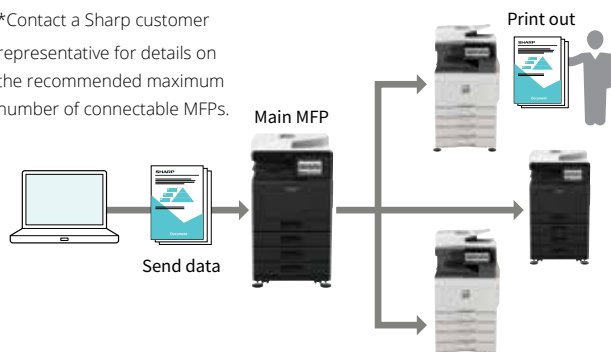

Document Filing

Document Filing allows files that have been copied, printed, scanned, or faxed* to be stored by job on the MFP's solid-state drive. From there, they can be instantly recalled for printing and sending at a later time. You can also combine multiple stored files into one, enabling easy and effective use of data.

*Fax requires optional MX-FX15, and Internet fax requires optional MX-FWX1. For fax and Internet fax jobs, only transmitted data (not received faxes) can be saved via the Document Filing function.

Quick File folder

Storing data in a Quick File folder lets you instantly reuse the file you need.

Main and Custom folders

Main folders can be assigned user names and shared across your workgroup. Custom folders require users to enter a password for access, so your sensitive data can be protected.

Secondary Ethernet Port*

A secondary Ethernet port allows the MFP to support two separate networks. You can set up different IP addresses and security settings for each line—one in-house, say, and one for visitors. Alternatively, the MFP could be set up to access a web-connected office network as well as a high-security offline network.

*Requires an Ethernet adaptor that supports two lines. Contact a Sharp customer representative for details.

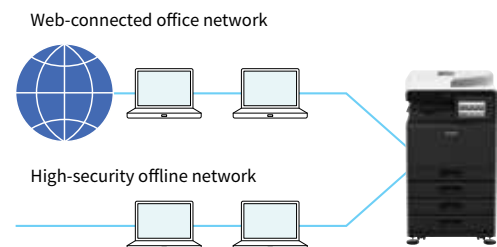

Sharp OSA* (Open Systems Architecture)

Sharp OSA technology allows you to interact with intra-company systems and network applications right from the LCD control panel. And since Sharp OSA utilises industry-standard network protocols, the MFP can easily integrate with third-party document management systems, enterprise resource planning software, workflow applications, and more.

*Requires optional MX-AMX2 and/or MX-AMX3.



Remote Operation*

The Remote Operation function lets you display the MFP's main control panel on the screen of your PC or mobile device. From a remote location, you can then check MFP settings or reprint data stored on the MFP.

*Requires VNC application. Simultaneous remote operation from two or more PCs or mobile devices is not possible. Remote operation also depends on the network environment and applications being used. Contact a Sharp customer representative for details.

Fits your security demands

- Want to protect confidential information.
- Want first-rate data safeguards.
- Want user peace of mind.

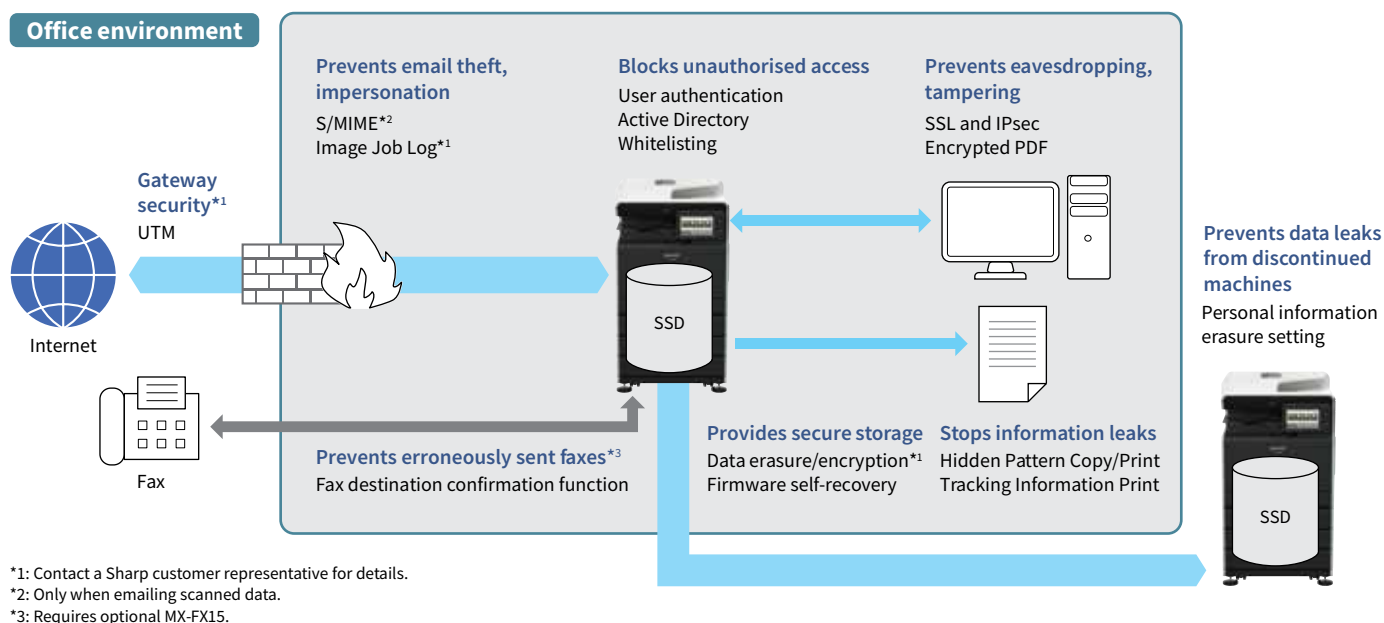

Document Control

This function prevents unauthorised use of confidential documents* by embedding copy prevention data in them.

*Requires optional BP-FR10U. May not work with certain types of paper, documents (such as those with a lot of photos), or MFP settings.

Hidden Pattern Copy/Print Function

Documents can be embedded with a watermark when they are output. The next time the documents are copied, a pattern or message appears in the background on the copy, thus effectively deterring unauthorised copying of confidential or personal information.

Tracking Information Print

This function prints the MFP user's name, the date, job ID, and other specifics on printouts, making it possible to track documents.

Data Encryption and Automatic Erasure*

Job data is encrypted before being saved to the MFP's internal storage. Once the data is output or sent, it is automatically erased.

*Contact a Sharp customer representative for details on activating this function.

Firmware Self-Recovery

Prevents firmware damage by quickly and automatically restoring files when abnormal firmware activity is detected.

Personal Information Erasure

Initialising the MFP allows you to delete personal information and other data stored on it. This security function helps prevent leakage of personal information and important documents after the machine is disposed of.

Active Directory®

By linking the MFP with Active Directory, users can access cloud services and network folders via the MFP by logging in with their authentication information. Beside the convenience of this single sign-on for users, system administrators can maintain a high level of security.

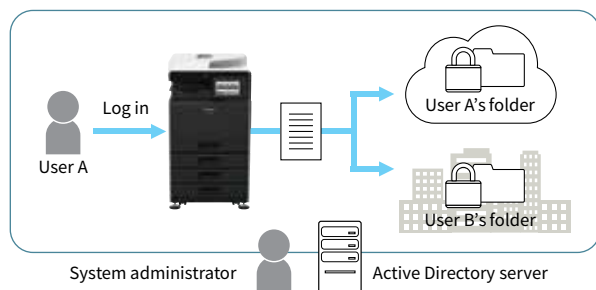

Server Authentication

The MFP supports external server authentication functions such as LDAP and Active Directory. With centralised management of multiple user credentials, system administrators can keep track of multiple MFP usage.

S/MIME*

Supports email encryption and digital signature. Sending emails in encrypted format keeps data from leaking. It also prevents someone from masquerading as the sender or altering the content of an email.

*Only when emailing scanned data.

Image Job Log*

This function creates and externally stores an image file (PDF) and a log file (XML) for each job. This helps identify unauthorised use of the MFD.

*Contact a Sharp customer representative for details on activating this function.

Whitelisting

Whitelisting protects the MFD from fraudulent programs trying to access the file system and obtain information.

SSL and IPsec

SSL (secure sockets layer) and IPsec data encryption technologies ensure secure network communications.

System Configuration

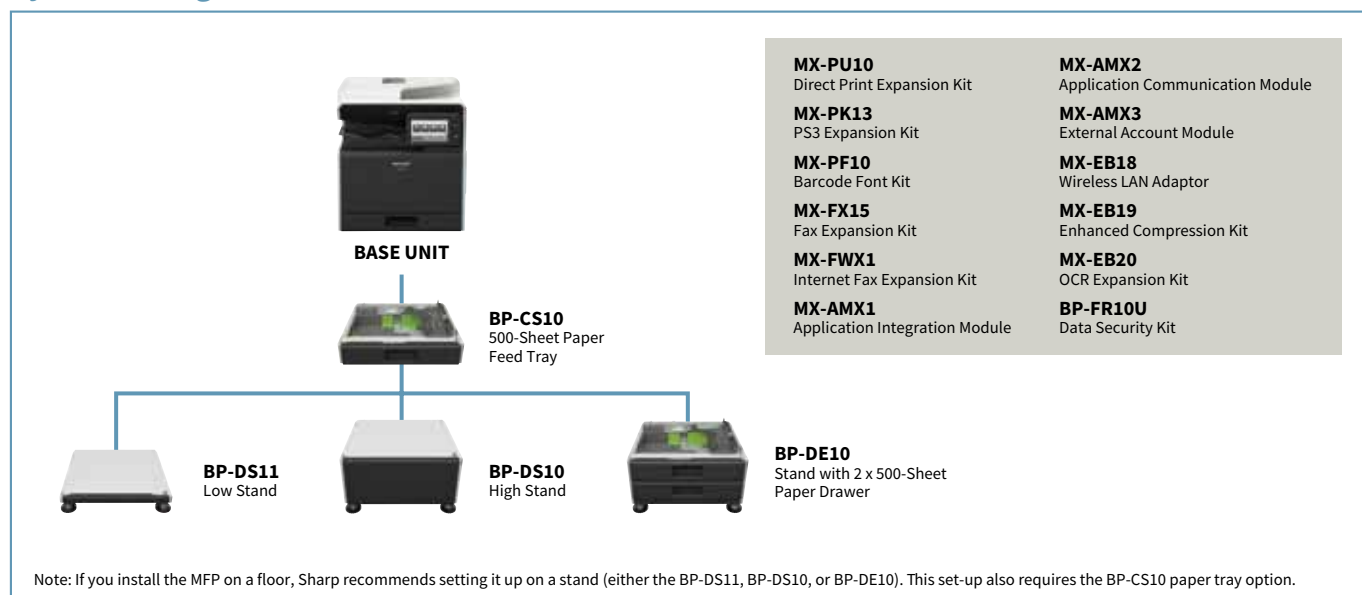

Certain optional equipment may not be available in some areas.

Specifications for Optional Equipment

BP-CS10 500-Sheet Paper Feed Tray

Paper size	A3 to A5 *1
Paper capacity	500 sheets
Dimensions (W x D x H)	560 x 560 x 145 mm
Weight (approx.)	6.7 kg

BP-DE10 Stand with 2 x 500-Sheet Paper Drawer

Paper size (Upper and lower tray)	A3 to A5*1
Paper capacity (Upper and lower tray)	500 sheets each
Dimensions (W x D x H)	560 x 585 x 329 mm
Weight (approx.)	21 kg

BP-DS11 Low Stand

Dimensions (W x D x H)*2	560 x 585 x 102 mm
Weight (approx.)	4.6 kg

BP-DS10 High Stand

Dimensions (W x D x H)*2	560 x 585 x 311 mm
Weight (approx.)	11 kg

Note: All specifications relating to paper capacity refer to 80 g/m2 paper.

*1: Only short-edge feeding can be used with A5 paper.

*2: Including adjusters and protuberances.

SPECIFICATIONS

General

Type	Desktop
Engine speed	A4*1: Max. 25 ppm A3: Max. 14 ppm
Control panel display	7.0-inch colour LCD touchscreen
Paper size	Max. A3W, min. A6*2
Paper capacity (80 g/m ²)	Standard: 350 sheets (250-sheet tray and 100-sheet multi bypass tray) Maximum: 1,850 sheets (350 sheets & optional 3 x 500-sheet tray)
Paper weight	Tray 1: 60 g/m ² to 105 g/m ² Trays 2-4 (BP-CS10/DE10): 60 g/m ² to 220 g/m ² Multi bypass tray: 55 g/m ² to 256 g/m ²
Warm-up time*3	17 sec.*4
Memory	5 GB (copy/print shared) 128 GB SSD*5
Power requirements	Rated local AC voltage $\pm 10\%$, 50/60 Hz
Power consumption	Max. 1.84 kW (220 V to 240 V)
Dimensions (W x D x H)	568 x 630 x 653 mm
Weight (approx.)	54 kg

Copier

Original paper size	Max. A3
First copy time*6	Colour: 11.0 sec. B/W: 8.0 sec.
Continuous copy	Max. 9,999 copies
Resolution	Scan (colour): 600 x 600 dpi Scan (B/W): 600 x 600 dpi, 600 x 400 dpi Print: 600 x 600 dpi, 9,600 (equivalent) x 600 dpi (depending on copy mode)
Gradation	Equivalent to 256 levels
Zoom range	25% to 400% (25% to 200% using RSPF) in 1% increments
Preset copy ratios	Metric: 10 ratios (5R/5E), inch: 8 ratios (4R/4E)

Scanner

Scan method	Push scan (via control panel) Pull scan (TWAIN-compliant application)
Scan speed*7	Colour & B/W: Max. 52 originals/min.
Resolution	Push scan: 100, 150, 200, 300, 400, 600 dpi Pull scan: 75, 100, 150, 200, 300, 400, 600 dpi 50 dpi to 9,600 dpi via user setting*8
File formats	TIFF, PDF, PDF/A-1a*9, PDF/A-1b, encrypted PDF, XPS, compact PDF*10*11, JPEG*11, searchable PDF*9, OOXML (pptx, xlsx, docx)*9, text (TXT [UTF-8])*9, rich text (RTF)*9
Scan destinations	Scan to email/desktop*12/FTP server/network folder (SMB)/USB drive/local drive

Document Filing

Document filing capacity*13	Main and custom folders: 5,000 pages or 500 files Quick file folder: 5,000 pages or 500 files
Stored jobs*14	Copy, print, scan, fax
Storage folders	Quick file folder, main folder, custom folder (max. 1,000 folders)

Printer

Resolution	600 x 600 dpi, 9,600 (equivalent) x 600 dpi
Interface	USB 2.0 (host, high-speed), 10Base-T/100Base-TX/1000Base-T, wireless LAN (IEEE 802.11 b/g/n)*15
Supported OS*16	Windows Server® 2012, Windows Server® 2012 R2, Windows Server® 2016, Windows Server® 2019, Windows® 8.1, Windows® 10 Mac OS 10.9, 10.10, 10.11, 10.12, 10.13, 10.14, 10.15
Network protocols	TCP/IP
Printing protocols	LPR, Raw TCP (port 9100), POP3 (email printing), HTTP, FTP for downloading print files, IPP, SMB, WSD
PDL	Standard: PCL 6 emulation Option: Adobe® PostScript® 3™
Available fonts	80 fonts for PCL, 139 fonts for Adobe PostScript 3

B/W Facsimile (requires optional MX-FX15)

Compression method	MH/MR/MMR/JBIG
Communication protocol	Super G3/G3
Transmission time	Less than 3 seconds*17
Modem speed	33,600 bps to 2,400 bps with automatic fallback
Transmission resolution	From Standard (203.2 x 97.8 dpi) to Ultra Fine (406.4 x 391 dpi)
Recording size	A3 to A5
Memory	1 GB (built-in)
Greyscale levels	Equivalent to 256 levels

- Design and specifications are subject to change without prior notice.
- Microsoft, Excel, PowerPoint, OneDrive, SharePoint, Active Directory, Windows Server, and Windows are either registered trademarks or trademarks of Microsoft Corporation in the US and/or other countries. QR Code is a registered trademark of DENSO WAVE INCORPORATED in Japan and other countries. Android, Gmail, and Google Drive are trademarks of Google LLC. The Google Drive trademark is used with permission from Google LLC. AirPrint and Mac are trademarks of Apple Inc., registered in the US and other countries. Box is a trademark, service mark, or registered trademark of Box, Inc. Dropbox is a trademark or registered trademark of Dropbox, Inc. PCL is a registered trademark of Hewlett-Packard Company. Adobe and PostScript 3 are either registered trademarks or trademarks of Adobe in the US and/or other countries. Qualcomm DirectOffice is a product of Qualcomm Technologies, Inc. and/or its subsidiaries. Qualcomm is a trademark of Qualcomm Incorporated, registered in the US and other countries. DirectOffice is a trademark of CSR Imaging US, LP, registered in the US and other countries. All other brand names and product names may be trademarks or registered trademarks of their respective owners.

Qualcomm® DirectOffice™

- *1: Long-edge feeding.
*2: Only short-edge feeding can be used with A6 paper.
*3: In a standard measurement environment. May vary depending on operating conditions and environment.
*4: When starting the MFP via the power button. 28 seconds when starting via the main power switch.
*5: SSD capacity depends on procurement and sourcing status.
*6: Long-edge feeding of A4 sheets from 1st paper tray, using document glass, MFP in fully ready condition. May vary depending on operating conditions and environment.
*7: Based on Sharp's A4 standard chart, using document feeder, long-edge feeding, one-sided scanning, and factory default settings. Scan speed will vary depending on the type of document and the scan settings.
*8: Resolution will vary depending on the size of the scanned area.
*9: Requires optional MX-EB20.
*10: Requires optional MX-EB19.
*11: Colour/greyscale only.
*12: Requires Network Scanner Tool Lite.
*13: Storage capacity will vary depending on the type of document and the scan settings.
*14: Some features require optional equipment.
*15: Requires optional MX-EB18.
*16: Mac OS requires optional MX-PK13.
*17: Based on Sharp's standard chart with approx. 700 characters (A4 long-edge feeding) at standard resolution in Super G3 mode, 33,600 bps, JBIG compression.

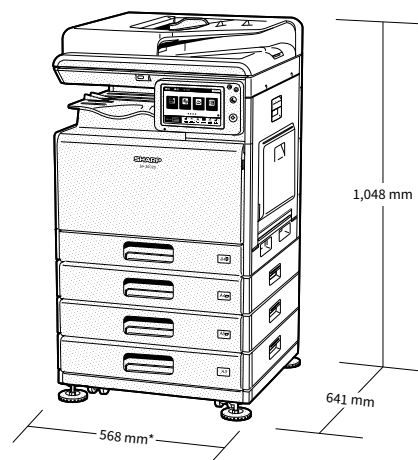

* 883 mm when multi bypass tray is extended.

Shown with optional equipment.

Distributed by:

SHARP

Be Original.

www.sharp.net.nz