

Slide 1

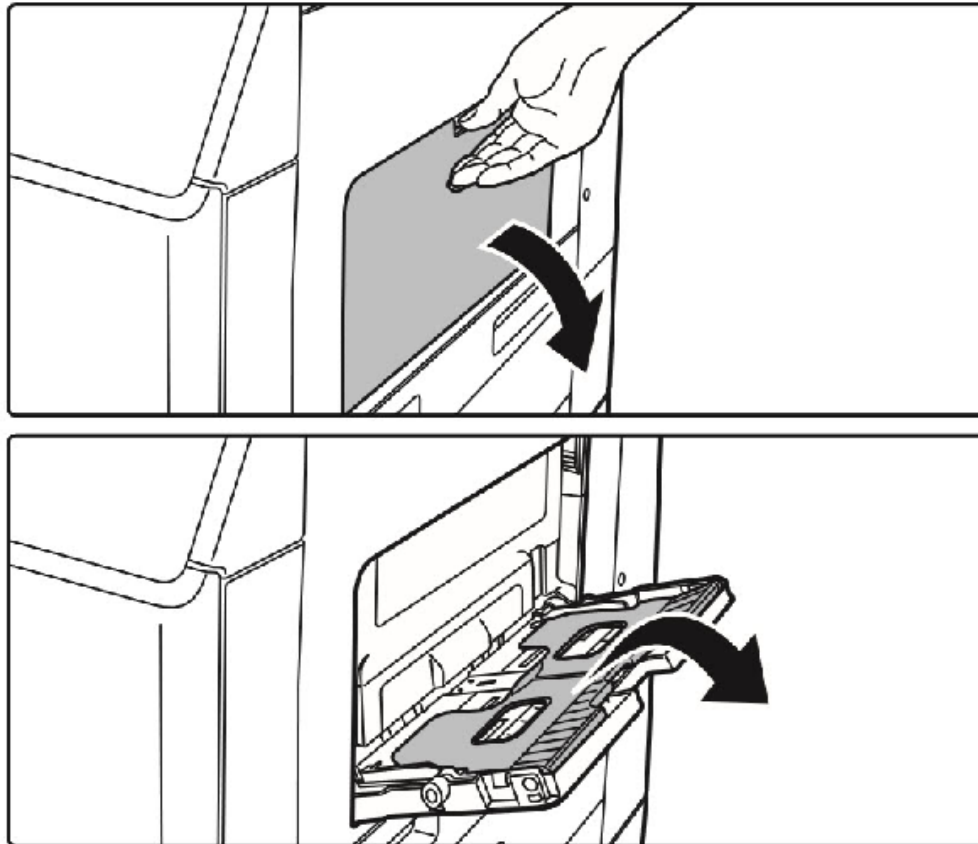

Slide 2



Open the **Bypass Tray** and the **Extension Tray**.

Slide 3

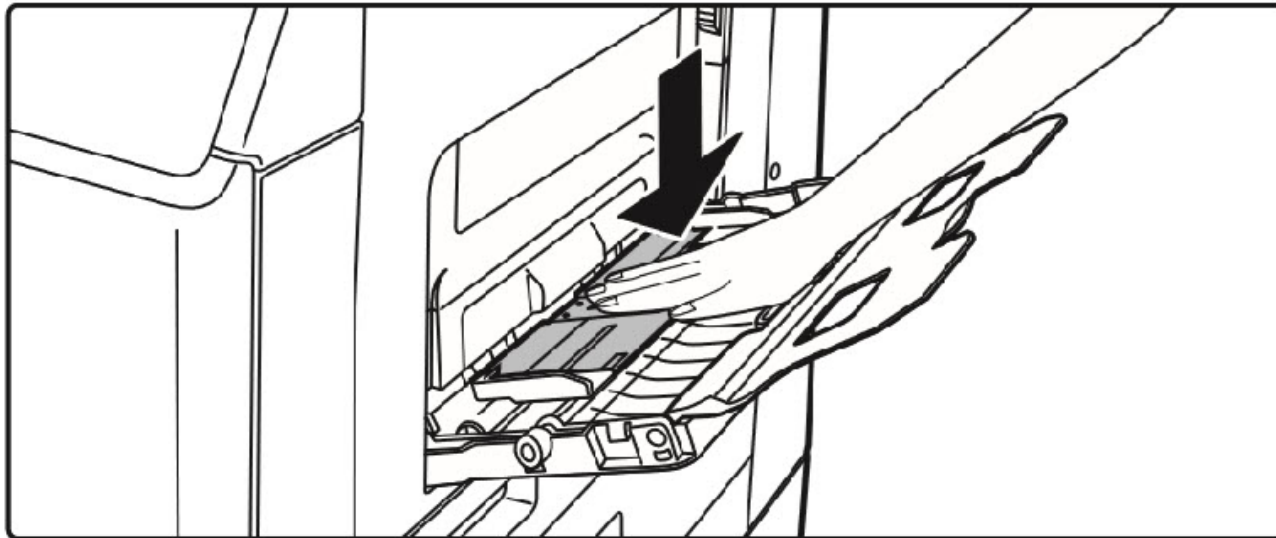

Push the center of the **Pressure Plate** down
until it **locks** into place.

Slide 4

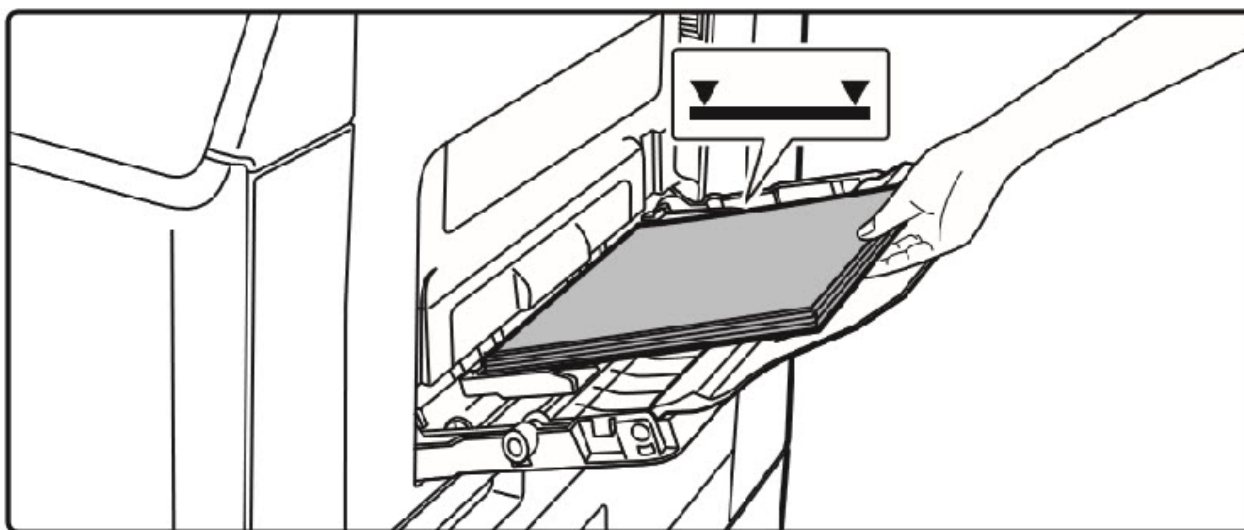

Insert the paper along the **Bypass Tray Guides** until it stops.

Slide 5

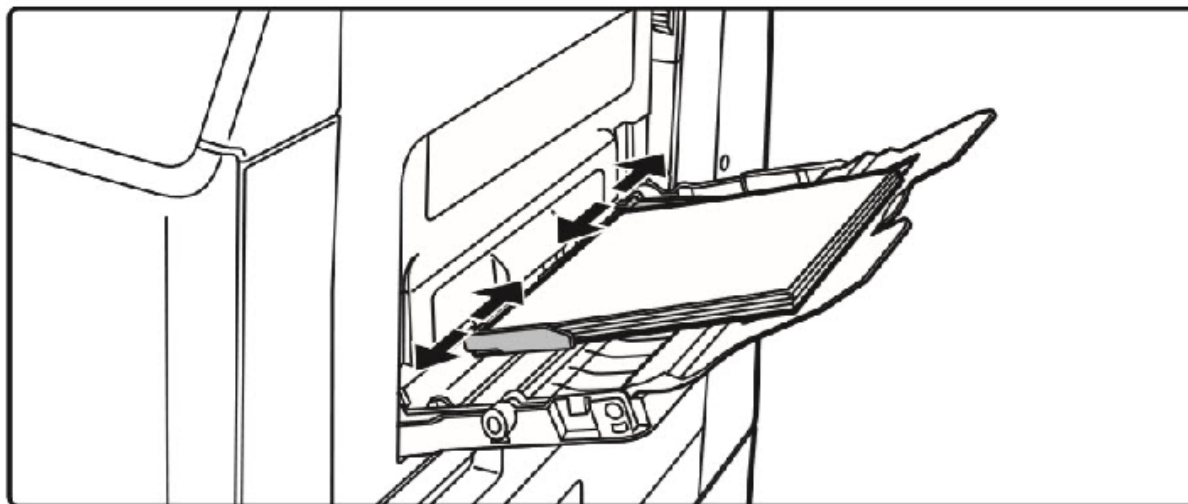

Set the **Bypass Tray Guides** to the width of the paper.

Slide 6

Congratulations, you have
Loaded the Bypass Tray.



MX-B376W
MX-B476W

SHARP